

From: [Allie Dunn](#)
To: [REDACTED]
Subject: CM: Response to request for information RE: Dannevirke Skatepark
Date: Monday, 11 November 2024 4:05:00 pm
Attachments: [image001.png](#)
[image002.png](#)
[image003.png](#)
[image004.png](#)
[image005.png](#)
[image006.png](#)
[image007.png](#)
[image008.png](#)
[Dannevirke Skatepark Proposal.pdf](#)

Kia ora

I refer to your official information request dated 31 October 2024 seeking information on costs to ratepayers and taxpayers associated with the Dannevirke Multisport Trust proposed construction of a skatepark at the Upper Domain in Dannevirke.

Copied below is a snip from the Council’s Long Term Plan 2024-34, page 130, that shows the funding allocated for the skatepark development. The Council’s Long Term Plan is available to view via our website, on the following page: [Long Term Plan | Tararua District Council](#).

Printed copies are also available to view at Council’s service centres and libraries.

This funding is from the Better Off Grant funding provided by the former Government, set aside for actioning the Council’s Play, Active Recreation and Sports Strategy, therefore this is funding from taxpayers. Also attached is a report that was considered by the Council at its meeting held 25 October 2023, regarding making provision from this grant fund towards the skatepark project. The agendas (including reports) as well as minutes from Council’s meetings are available to view on our website, on the following page – note you will need to change the viewing year to the 2023 year to access previous years’ agendas and minutes:

[Agendas, Minutes & Meeting Videos | Tararua District Council](#)

COMMUNITY FACILITIES AND SERVICES - CAPITAL EXPENDITURE

Ngā Whare me ngā Ratonga Hapori Community Facilities and Services

Whakapaunga Haupū Rawa Capital Expenditure

	Year 1 2024/2025 \$000's	Year 2 2025/2026 \$000's	Year 3 2026/2027 \$000's
Growth			
District New Berms	31	31	-
Mangatera Cemetery Development	103	-	-
Woodville Camp Grounds Ablution Block Renewal	-	-	36
Total Capital Expenditure for Growth	134	31	36
Level of Service			
Carnegie Options Assessment	185	-	-
Carnegie Re-Design and Re-Development	-	157	1,072
Dannevirke Dog Pound Improvements	-	46	-
Dannevirke Multisport Park - Skatepark Development	51	-	-
Mangatainoka Cemetery Development	15	-	-
New Pahiatua Pool*	3,701	2,622	-
Total Capital Expenditure for Level of Service*	3,953	2,825	1,072

Ngā mihi



Allie Dunn | Manager - Democracy Services

Strategy & Community Wellbeing - Democracy Services | Tararua District Council

Phone: +64 6 3744080 | Mobile: +64 27 3331626

Allie.Dunn@Taruadc.govt.nz

26 Gordon Street, Dannevirke 4930, PO Box 115

www.taruadc.govt.nz

www.facebook.com/taruadc

Now is the time to consider water blasting properties, filling tanks, pools and spa's ahead of the drier summer months...



...to reduce the risk of restrictions.



From: Allie Dunn

Sent: Thursday, October 31, 2024 2:41 PM

To: [REDACTED]

Subject: CM: Acknowledgement - request for information RE: Dannevirke Skatepark

Kia ora

This email is to acknowledge receipt of your request for information, regarding costs to taxpayers and ratepayers associated with the proposed construction of a skatepark at the upper domain in Dannevirke.

We will endeavour to respond to your request as soon as possible and in any event no later than 28 November 2024, being 20 working days after the day your request was received. If we are unable to respond to your request by then, we will notify you of an extension of that timeframe.

As part of our commitment to openness and accountability, we are now proactively publishing copies of requests for information and the responses provided to these requests, on our website. In doing so, we will ensure we comply with the provisions of the Privacy Act 2020 and redact any personal / identifying information from any response published.

If you have any questions about this, please don't hesitate to get in contact with me.

Ngā mihi

Allie Dunn | Manager - Democracy Services

Strategy & Community Wellbeing - Democracy Services | Tararua District Council



Phone: +64 6 3744080 | Mobile: +64 27 3331626
Allie.Dunn@TararuaDC.govt.nz
26 Gordon Street, Dannevirke 4930, PO Box 115
www.tararuaDC.govt.nz
www.facebook.com/tararuaDC

From: [REDACTED]
Sent: Thursday, 31 October 2024 1:41 pm
To: Info - Tararua District Council <Info@TararuaDC.Govt.NZ>
Subject: Dannevirke Skatepark.

EXTERNAL EMAIL ALERT: Caution advised. This message is from an external sender. Verify the sender's identity and use caution with attachments and links.

Could you please Provide Details of all TDC Grants, Funding, and any other Costs to Taxpayers and Ratepayers, associated with the Dannevirke Multisport Complex Inc Proposed Construction of a Skatepark to be situated at the Upper Domain in Dannevirke? Thanks.

[REDACTED]



Report

Date : 17 October 2023

To : Mayor and Councillors
Tararua District Council

From : Jessica McKenzie
Manager Facilities

Subject : **Dannevirke Multisport Complex Incorporated (DMCI) Proposed Dannevirke Skate Park Project**

Item No : **9.1**

1. Recommendation

- 1.1 ***That the report from the Manager Facilities dated 11 October 2023 concerning the Dannevirke Multisport Complex Incorporated (DMCI) Proposed Dannevirke Skate Park Project be received, and***
- 1.2 ***That Council approve the use of 1266 metres squared more or less of Suburban Section 12 Dannevirke and Section 94-95 Block III Tahoraiti Survey District for a skate park facility in Dannevirke, and***
- 1.3 ***That Council support DMCI undertaking further investigation to progress the development of a skate park facility in Dannevirke, and***
- 1.4 ***That Council give consideration to the Dannevirke Skate Park for financial support from the Three Waters Better Off Grant Fund project of actioning Council's Play, Active Recreation and Sports Strategy as part of the investment planning cycle starting with the 2024-2034 Long Term Plan.***

2. Reason for the Report

- 2.1 Council's approval for the use of 1266 metres squared more or less of Suburban Section 12 Dannevirke and Section 94-95 Block III Tahoraiti Survey District for a skate park facility in Dannevirke.
- 2.2 Council's support of DMCI undertaking further investigation to progress the development of a skate park facility in Dannevirke.

- 2.3 For Council to consider the Dannevirke Skate Park for financial support from the Three Waters Better Off Grant Fund project of actioning Council's Play, Active Recreation and Sports Strategy as part of the 2024-2034 Long Term Plan.

3. Background

- 3.1 In 2021, the Dannevirke Multisport Complex Incorporated (DMCI) was approached by the Dannevirke Recreation Committee to assist with the project of developing a new Dannevirke skate bowl.
- 3.2 DMCI are a community organisation that aims to improve activation and recreation levels in all age groups, demographics and codes within the Dannevirke community and surrounding catchment. DMCI's vision is to increase the number of tamariki and rangatahi participating in sport and recreation in the community and to provide the Dannevirke community with fit for purpose sport and recreation facilities. The opportunity to develop a new and improved skate park for the benefit of the community aligns with DMCI's purpose and vision.
- 3.3 As the two community organisations saw synergy and alignment in their purpose and visions, the Dannevirke Recreation Committee decided to wind up and combine with DMCI.
- 3.4 DMCI has a long term plan to create a play, recreation and sports hub in Dannevirke and have included the development of the new skate park as phase one of that plan, with phase two and three looking at building a stadium, all weather courts and turf.
- 3.5 DMCI are seeking funding to build a skate park in Dannevirke. This development would replace the existing skate bowl which is no longer fit for purpose. The location of the proposed new skate park is alongside the playground at the Dannevirke Upper Domain.
- 3.6 The Dannevirke Domain Reserve Management Plan (September 2010) is supportive of further development on the reserve for recreational purposes. It states with reference to further development: it is proposed that the management of the Domain should continue to focus on providing a mix of passive and active recreation opportunities. The strategy proposed in the Plan is to allow for the possibility of future development in the Upper Domain by identifying sites for development to occur if and when the local community can source funding. Further it states the management of the Domain and future development is a partnership between the community, clubs and organisations that operate on the Domain and the Council. The Plan references having great involvement and support from the community in future developments and maintenance and using community groups to enhance the facilities of the Domain through grant funding.
- 3.7 The proposed skate park will be designed to meet the needs of a range of wheel sports and meet the needs of a wide range of ages and abilities. The flow of the skate park will be designed so that all users can use the facility without impeding on each other's space. Some features will include a flat area, small bumps, steps

and jumps. The final design has yet to be completed as this is subject to funding. The skate park can be designed around the existing Easton Fountain on site.

- 3.8 Two companies were contacted to tender for the design of the skate park and have submitted their proposals for consideration. DMCI have met with the TDC Planning Team for a preliminary assessment. A detailed assessment would be undertaken on an application or proposal of the development.
- 3.9 The total project cost is estimated to be \$443,966. Committing to construction is dependent on raising the required funds. DMCI have developed a fundraising plan and recognise that funding can change from year to year and may need to re-evaluate their plan over time.
- 3.10 As part of the fundraising plan, DMCI are seeking consideration from TDC for \$50,000 from the Three Waters Better Off Grant Fund project of actioning Council's Play, Active Recreation and Sports Strategy as part of the 2024-2034 Long Term Plan.
- 3.11 DMCI have been advised by Bush Multisports Trust that the grounds maintenance cost of the wheels park in Pahiatua is minimal, therefore DMCI envision this to be the same for the Dannevirke skate park. However, DMCI will budget \$2000 annually for costs incurred from potential vandalism and graffiti.
- 3.12 On completion of building the skate park, DMCI propose to retain ownership and management of the skate park. DMCI propose having a memorandum of agreement in place with Tararua District Council detailing the ongoing responsibilities related to the skate park.
- 3.13 DMCI commissioned an Activation Manager to develop the Business Case for the Dannevirke Skate Park project. The high level analysis has confirmed that developing a skate park facility in Dannevirke would align with Council's strategic direction and better meet the needs of the Dannevirke community than the existing skate bowl.

4. Significance Assessment

- 4.1 With regard to Council's Significance and Engagement Policy this report is not considered significant as there is no change in use of the land and the impact on rates is within the Financial Strategy limit.

5. Consultation

- 5.1 In March 2020, the then Recreation Committee created a survey to see what the Dannevirke community thought about the current skate bowl and other recreational facilities in Dannevirke. The survey showed that the community did not think there was enough recreational activities for children in Dannevirke and that the current skate bowl was not seen as being a very important feature of the town. Up to 30% of those people surveyed stated that they were travelling outside

of Dannevirke to use other wheel park facilities. The survey further identified that the Upper Domain was the most used recreation space in Dannevirke.

- 5.2 In April 2020, a school holiday competition was run by the Recreation Committee and Sport Manawatu that asked the tamariki to come up with a design for the skate park with features they would like to see included. Students from Huia Range School won the competition.
- 5.3 In November 2020, a community recreation consultation was held by the Recreation Committee at the Upper Domain to discuss the draft concept plan for the skate park at the Upper Domain.
- 5.4 In April 2021, the Recreation Committee ran a sausage sizzle during the school holidays at the existing skate bowl and surveyed the tamariki to ask if they wanted a skate park, pump track or a skate bowl. The results concluded that scooter riding was the most popular activity and the tamariki preferred a skate park and/or a pump track.
- 5.5 Through Tararua District Council's Play, Active Recreation and Sport Strategy consultations held throughout 2022, found there is growing demand for skate parks and wheel parks. These spaces are a critical provision for informal self-directed play and are heavily used by tamariki, rangatahi and sometimes adult residents to practice and develop their skills, play and socialise. Feedback from the Dannevirke community was that the current skate park was under-sized and in sub-optimal location.
- 5.6 In July 2023, the DMCI Activation Manager went into St Joseph's School to ask what they didn't like about the current skate bowl and what they would like in a new skate park. The students feedback was that the current skate bowl was unsafe and the design did not allow for multiple users at one time.
- 5.7 In September 2023, DMCI sought feedback and involvement from the local Iwi. Following this, Ngāti Kahungunu ki Tāmaki nui-a-Rua (Ngāti Kahungunu) reached out to DMCI to discuss the option of incorporating a half basketball court into the design to meet the needs of the local rangatahi.
- 5.8 Further consultation with Police and other community stakeholders has taken place to gain the different perspectives and feedback on the skate park project. Overall, the feedback has been supportive and the proposed new location at the Upper Domain would be a safer area and a better site for families as the playground, swimming pool and sports and recreation fields are nearby.
- 5.9 DMCI will work closely with the community to finalise the skate park design by utilising social media, engaging with local schools and community stakeholders, and holding community hui.

6. Conclusion

- 6.1 In conclusion, Dannevirke Multisport Complex Incorporated are seeking to progress the development of the proposed new skate park at the Dannevirke Upper Domain and aim to seek funding to enable the build.
- 6.2 This report explains the background and presents information from the business case developed by the DMCI Activation Manager.

Attachments

- 1 [↓](#). Dannevirke Multisport Complex Inc - Dannevirke Skate Park Proposal - Business Case - August 2023
- 2 [↓](#). Dannevirke Multisport Complex Inc - Dannevirke Skate Park Proposal - Business Case Supporting Documents - August 2023

Dannevirke Skate Park Development Business Case



**Presented by: Dannevirke Multisport complex
Incorporated
August 2023**

Contents

1. Summary	3
2. Background	3
3. Proposal	4
4. Strategic Alignment.....	4
5. Community Need	5
6. Community consultation.....	7
7. Current skate Bowl.....	12
8. Proposed site	12
9. Proposed Skate Park	13
10. Examples of different designs.....	14
11. Costings.....	15
12. Ownership and Management	18
13. Project Funding and Timeline:	18
Grant Applications	19
Other Fundraising Activities.....	19
Other Funds	20
14. Conclusion.....	20
16. Supporting Documents	21

1. Summary

The following document is a proposal by the Dannevirke Multisport Complex Incorporated (“DMC”) for investment from the Tararua District Council (“TDC”) to develop and improve the current Dannevirke Skate Bowl.

2. Background

The suitability of the Dannevirke Skate Bowl to meet current and future recreational needs of the Dannevirke community has been an issue for a number of years.

This issue was first brought to the attention of TDC in 2018, when a group of young people approached Mayor Tracey Collis to express their dissatisfaction with the Skate Bowl. In a Hawke’s Bay Today article titled, “Young campaigners roll up to mayor with skatepark plea”, Dave Murdoch reported that people were travelling out of town to use the new wheels park in Pahiatua, rather than using the Skate Bowl in Dannevirke. The article said that young people found the Skate Bowl “a bit boring” and that they would like a bigger area. The issue was brought to the attention of TDC again in 2020, when a group of children and their parents requested a meeting with Mayor Tracey Collis to discuss their concerns with the Skate Bowl.

During that discussion the Mayor was informed that the Skate Bowl was dangerous and the concrete too coarse, with one teenager stating, “it eats your skin”. The group also expressed concern that the skate bowl was too small for the number of people using it and that this endangered smaller scooter riders and could lead to major collisions.

Then, in 2021, DMC was approached by the recreation committee who wanted our help running a project to develop and improve the Skate Bowl. They saw that DMC was already an established committee with similar goals for the community.

DMC jumped at this opportunity. DMC are an organisation that aims to improve activation and recreation levels in all age groups, demographics, and codes within the Dannevirke community and surrounding catchment. DMC’s vision is to provide the Dannevirke community with modern sport and recreation facilities. The opportunity to develop and improve the Skate Bowl a new and improved skate park for the benefit of our community aligns perfectly with our DMC’s purpose and vision – to increase the number of tamariki and rangatahi who are active in our community.

DMC has a long-term plan to create a “hub” that provides the Dannevirke community with modern sport and recreational facilities, and opportunities that are currently only available to people if they travel outside of the district. We have included the development and improvement of the Skate Bowl as phase one of that plan, with phase two and three looking at building a stadium, all weather courts, and turf.

When DMC became involved in this project, we decided to run a survey on Facebook, in conjunction with Sport Manawatu/Tararua, to see what our community thought about the Skate Bowl and other recreational facilities in Dannevirke. This survey showed that our community did not think there were enough recreational activities for children in Dannevirke and that the Skate Bowl was not seen as being a very important feature of the town.

In a subsequent survey, we found that most children in Dannevirke rode scooters and wanted a Skate Park where they could practice their skills to a higher level than the Skate Bowl allows. Up to 30% of those people surveyed stated that they were travelling outside of Dannevirke to use other towns wheel park facilities.

It was clear from these surveys that the Skate Bowl was in desperate need of an upgrade, and in February 2022 DMC commenced a community investigation into the development of a new and improved Skate Park for our community and the surrounding catchment.

This investigation involved a public presentation at the Skate Bowl and another at the Dannevirke Upper Domain. The outcome of those presentations was that, given the growing popularity of wheel sports, there was insufficient room at the current Skate Bowl site to accommodate the needs of people who rode skateboards and scooters. It was also clear that the current Skate Bowl site is poorly lit and located away from other recreational facilities.

It was suggested that the Dannevirke Upper Domain may be an appropriate site for a Skate Park, and on further consultation with the community, DMC were told by members of the community that having a Skate Park at the Upper Domain “would be a safer area for riders” and that it was “a good site for families”. DMC are confident that this site aligns with our vision to create a Skate Park that accommodates people of all ages. The Upper Domain, with its playground and pools nearby, is already a safe, family friendly area. Having the Skate Park located here would enable parents to bring their children to the Upper Domain to learn to scooter, bike, skate and enjoy the facilities that are already located there. The Upper Domain is a safe environment with CCTV cameras and sufficient lighting, aligning perfectly with Crime Prevention through Environmental Design principles – surveillance, access management, territorial reinforcement, and quality environments.

As part of DMC’s investigation, we have also consulted local primary schools, the local youth centre and iwi about our plans and have received overwhelmingly positive feedback.

DMC’s extensive investigation has confirmed to the organisation that the development and improvement of the Skate Bowl is essential for Dannevirke to be able to continue to cater to the needs of our youth and their whanau. DMC’s position is that a new and improved Skate Park will help to improve the social well-being of our young people, meet the needs of local communities, and address issues of affordability that may otherwise be a barrier to Dannevirke residents accessing skate park facilities in other parts of the district and beyond.

3. Proposal

DMC is seeking investment from the TDC and other funders to develop the new Dannevirke Skate Park. DMC’s proposal is that a new Skate Park be developed in the Dannevirke Upper Domain.

The total cost of the project is estimated to be \$443,966.00, however DMC are hoping to decrease this cost by obtaining sponsorship from local businesses and work in-kind. We have already applied to the Lions Club for funding of \$3,000.00 which will enable the design and tender process to be completed.

For DMC to commit to construction we need to know that we have the funds available to complete the project. DMC are proposing that the Skate Park be owned and managed by DMC and that, on completion of the Skate Park, a memorandum of agreement is signed addressing ownership and ongoing maintenance requirements.

4. Strategic Alignment

The TDC is progressing a Play, Active Recreation and Sport Strategy that is focused on enhancing and increasing participation in play, active recreation and sport to improve the Hauora/wellbeing of

people living in the Tararua district. The Strategy's purpose is to provide guidance to the TDC Tararua District Council on the future direction of play, active recreation and sport in the district over the next 10-30 years and to meet the changing demands and needs that are already impacting current provision. The Strategy investment framework is intended to be used by Council to assess the relative merit or value of projects for financial support at key points in the investment planning cycle starting with the 2024-2034 Long Term Plan. That Long Term Plan states that population growth will result in increasing demand for development of reserves to accommodate walkways, cycleways, and most importantly, Skate Parks. It is DMC's position that developing and improving a new Skate Park for the Dannevirke community aligns perfectly with the goals of the TDC's Play, Active Recreation and Sport Strategy, and Long Term Plan.

DMC's proposal also aligns with several other organisations objectives to get our communities moving.

Sport New Zealand states that play, active recreation, and sport make a significant contribution to the wellbeing of our people, particularly Māori, by strengthening intergenerational relationships and reinforcing cultural values, beliefs, social norms and knowledge. Their position is that investment in play, active recreation and sport programmes, and suitable spaces and places, in the right locations enables improved physical activity levels and improves the quality of the participant experience, delivering benefits to local communities by increasing social connectedness and cultural identity/ūkaipōtanga, and improving health and social wellbeing, environmental quality, and access to participation opportunity.

The Ministry of Health states in its Childhood Obesity Plan that being physically active at each stage of life, and specifically in early childhood, lowers the chance of a child becoming obese. With just over 20% of the Dannevirke population being under the age of 15, it is essential that they are provided with recreational facilities that enable them to be physically active. A Skate Park provides many different ways in which a young person can be physically active.

Similarly, the Tararua Te Mahere Hauora Health and Wellbeing Plan (2018-2023) aims to "encourage and support healthy and active living for everyone", "provide local initiatives that help people make good lifestyle choices" and "better link people to community initiatives so people can stay active, eat well and be connected to their community".

It is also worth noting the Department of Conservations goal for recreation reserves, which is to provide "areas for recreation and sporting activities" and to promote and support "the physical welfare and enjoyment of the public", and Sport Manawatu's purpose statement, which is to "get everyone active through play, active recreation and sport".

DMC's position is that a Skate Park is an ideal recreational facility to encourage people, particularly youth, to stay active, and connect with their community, and that it aligns perfectly with several organisations objectives to promote the many benefits of physical activity.

5. Community Need

The Tararua District is characterised by small towns and a low population density of 3.9 people per km² (compared to all NZ: 15.7). Due to lack of community/recreation services, people are often traveling outside the district to meet their social and recreation needs.

This presents challenges in terms of the need to travel to community/recreation services and facilities to meet people's social and recreation needs. The nearest skate facility to Dannevirke is in Pahiatua, a 32-minute driveaway. The nearest wheel park facility is in Palmerston North, a 50-

minute drive away. This presents problems for many families. Traveling these distances is not possible for many people which means our tamariki and rangatahi are missing out on engaging in free and unstructured play, which skate and wheel park facilities are so good for.

The proposed skate park will be the only one of its kind for Dannevirke and surrounding catchments, therefore it is envisaged that it will enhance the existing facilities at the park and in the future the multi-sport complex.

Wheel Parks are now a critical provision for informal self-directed active recreation and are heavily used by tamariki, rangatahi and by adult residents to develop and practice their skills and have fun. Groups will often gather at these facilities to play and socialise, particularly those sites with appropriate support facilities and services.

With just over 20 percent of the population of Dannevirke being under 15 years old it is important to provide them with an area that caters to their needs. DMC believes that giving our tamariki and rangatahi a suitable safe space in their own community will foster these connections.

The Global Leisure Group found that Places to meet / gather in spaces and facilities are critical. Most active recreation and sport activities by their nature foster meaningful social connectedness via face-to-face interaction and this social capital is increasing in importance in our virtual/ digital screen focused age. A new Skate park in a safer area would encourage more children of all ages and backgrounds to meet and encourage them to play together and increase the social interaction of our community.

It is clear from research done by the Global Leisure Group by surveying 16 schools in our community 6 of these are based in Dannevirke and there is a need for an upgrade. They stated in their PARS strategy that one of the key needs for Dannevirke was to replace the skate/scooter park.

- Dannevirke students are very keen for a new skate park

Participation in outdoor recreation activities is growing and so too is the provision of spaces and places for outdoor recreation. Less usage of traditional sports fields, higher demand for mountain biking, skate parks, basketball half courts etc. More local facilities are needed for casual recreation. The global leisure group found that there is a move away from structured traditional activities and clubs – participants just want to have a game or a ‘run around’ without committing to training ahead of games. A new and improved skate park would meet this need.

Currently the town has six local primary schools with three primary schools in the outlying areas and three colleges. Dannevirke also has two kindergartens run by the Dannevirke Kindergarten Association with a combined roll of 80 children and four early childhood education centres that have a combined roll of 159 children.

Refer to Table One for pupil numbers.

Table 1

Schools/colleges in Dannevirke area	Number of pupils (<i>education counts July 2022</i>)
Dannevirke high school	410
Totara College	61
Te Kura Kaupapa Maori O Tamaki Nui A Rua	81
Dannevirke South School	260
Huia Range School	270
St Josephs Dannevirke	144
Ruahine	168
Norsewood	75
Weber	43

A survey was sent out to the community with 202 people stating they travel out of town for recreational activities almost 30% of these specifically stated this was for the use of a skate/wheel park.

We know that parents are taking their children out of town to use these facilities. “We go most weekends,” said a mother of two young children when we spoke to her. “We always grab a coffee and some snacks while the kids are skating, it’s a shame we can’t do this in town and support our local cafés”.

6. Community consultation

Consultation with stakeholders and the local community has taken place in the form of public presentations and community “get togethers”. Presentations have been done in local primary schools and there has been communication with local Iwi who support this project as well. The local police have also been consulted to make sure the area for the proposed move is a safe area. They support this move as there is good lighting and CCTV available. Once funding has been accepted, we will work with our community to come up with a suitable design.

In March 2020 the recreation committee created a survey to send around to our community. These questions were designed around asking the community if they felt there were enough recreation spaces for our tamariki and rangatahi and what spaces they already used in our community. It can be seen from the results that there is a convincing number of our community that do not believe there are enough spaces for our youth in Dannevirke.

The survey also pointed out that the upper domain was currently the most used recreation space in our community which helped make the decision to move the skate park to this area.

Dannevirke Recreational Space Survey

SurveyMonkey

Q1 Do you believe there are enough activities in our recreational spaces for the youth in Dannevirke?

Answered: 305 Skipped: 0

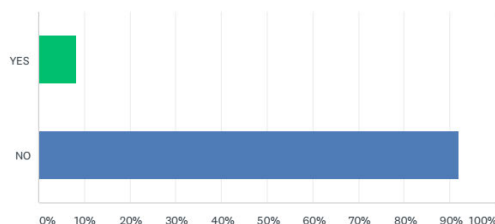

7

**Q4 What recreational space (park or reserve) do you currently use?
 Please tick all that apply.**

Answered: 305 Skipped: 0

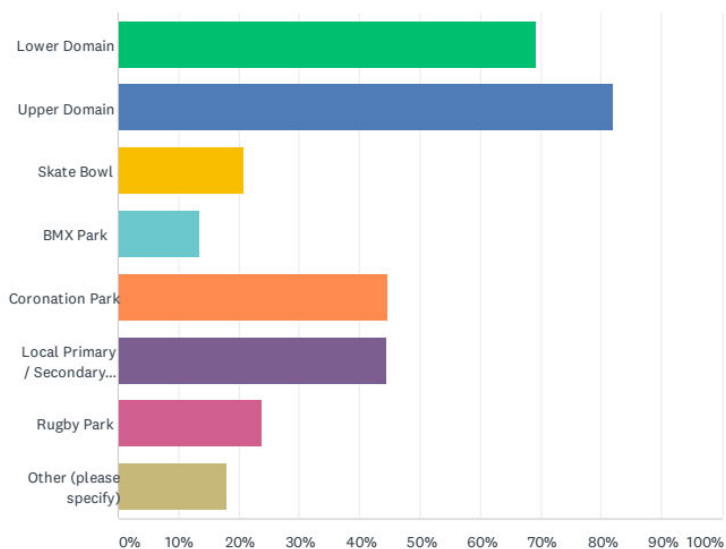

ANSWER CHOICES	RESPONSES	
Lower Domain	69.18%	211
Upper Domain	81.97%	250
Skate Bowl	20.66%	63
BMX Park	13.44%	41
Coronation Park	44.59%	136
Local Primary / Secondary Schools	44.26%	135
Rugby Park	23.93%	73
Other (please specify)	18.03%	55
Total Respondents: 305		

Q5 If you are not currently using a recreation space (park or reserve) in Dannevirke, please tick all the reasons why.

Answered: 289 Skipped: 16

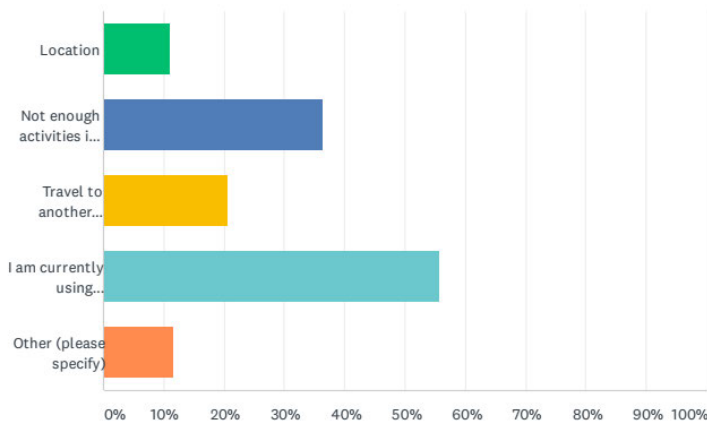

ANSWER CHOICES	RESPONSES
Location	11.07% 32
Not enough activities in the park/reserve	36.33% 105
Travel to another recreational space in another town/city	20.42% 59
I am currently using Dannevirke recreation spaces.	55.71% 161
Other (please specify)	11.42% 33
Total Respondents: 289	

Following on from the survey a School holiday competition was run in April 2020. The recreation committee asked the tamariki to come up with a design for the skate park with things they would like to see included. The committee then joined with sport Manawatu to help promote the competition and donate some prizes.

Students from Huia range school won the competition. Mayor Tracey, Erana from the recreation committee and Deanne from Sport Manawatu then went to the school to talk about the design and gather ideas from the students.



9



On Monday the 2nd of November 2020 a community recreation consultation was held at the upper domain. During this consultation the committee went through a draft concept plan of the upper domain and talked about the plan. There was a good turn out from the community. The committee welcomed ideas from the guests and some of the suggestions made were to add a bike pump and some seating for parents and Grandparents.



In the April 2021 school holidays the recreation committee ran a bbq and presented a survey designed for the Children to ask if they wanted a skatepark, pump track or a skate bowl.

The survey also asked what days and times were the most popular and how many days a week they used the current skate bowl. The results for this showed that scooter riding was the most popular and that the children wanted a skatepark and a pump track.

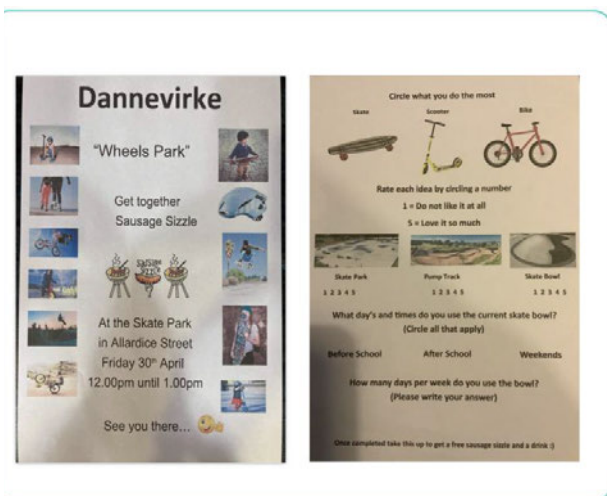

In July 2023 now under DMC, an activation manager went into St Joseph's school to gain further student voice. The students were asked what they didn't like about the current skate bowl and what they would like in a new Skate park. The students had voiced their concern about the safety of the area and mentioned that the design did not allow many people to be there at the same time. The students also discussed that they did not feel safe at the current skate bowl.

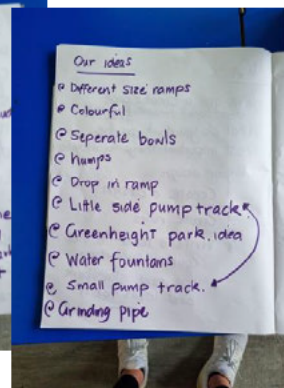
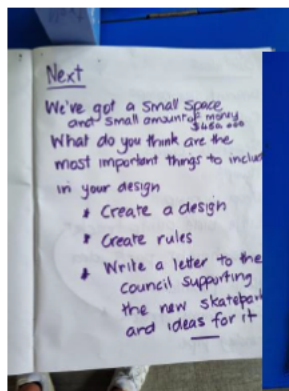
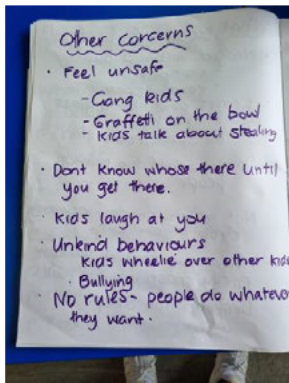
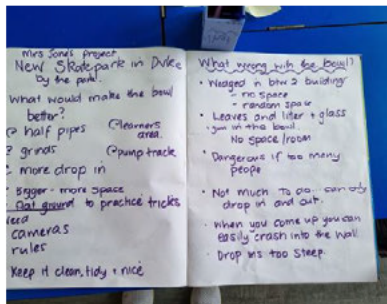

DMC will work closely with the community to finalise the design. Both companies will be completing a site visit and drafting a first design. DMC will then take to the community to gain feedback before agreeing on a final design. This will be done by utilising our social media, going into schools, holding a community hui.

In September 2023 DMC approached Iwi to discuss options and gain input. Ngati Kahungunu then reached out to DMC to discuss the option of incorporating a half basketball court into this design as this is something they have been wanting for the rangatahi for a long time. DMC and Ngati Kahungunu have been working together to make this design possible.

7. Current skate Bowl

At present in Dannevirke there is a designated area beside the old fire station where the bowl is located, the area is inadequate in terms of size, has poor visibility and does not meet the needs of the youth of today. According to the global leisure group the Dannevirke facility is under-sized and in a sub-optimal location in the commercial area.

Working with a local school in the community they had given us a list of reasons as to why they did not think the current skate bowl was meeting their needs. At the top of this list was that they felt unsafe. Being tucked away there is little visibility and no walk through traffic. There are no cameras in this area and it is not somewhere that families often go. This means lack of adult presence. The positioning of the bowl means that it is very close to the surrounding buildings. There is little room for stopping at the top. One student stated that “when you come out of the bowl you can hit the wall”. They were concerned about the size saying that when there are lots of people there it can become dangerous.

Skating has evolved throughout the years and has developed as a youth subculture that emphasizes creativity and individuality. The current bowl does not allow the children to maximise this creativity due to lack of space and functionality. There needs to be more features that allow the children to enhance their skill level. Some of the comments made by the students were that it was a bit boring and doesn't allow us to practice our tricks.



8. Proposed site

The proposed skate park is reasonable with an achievable cost structure being broken down into stages. The location is sensible given vehicle access, user demand, visibility, and safety.

The site of the proposed skate park is adjacent to Wai Splash community pools and alongside the local park and next to the athletics track. This is in an ideal location to have optimised use from families who have a varied age range of children and for siblings waiting for parents to finish with swimming lessons or while at athletics training. The remaining land in between the pools and the park will soon become the space for the multi-sport complex. This will make the skate park central to all sporting activity.

The site is ideal for a skate park, there is plenty of space as it currently holds an old garden that was donated by the lion's club that needs refreshing and a fountain that is no longer in use. Both of these structures require maintenance by the council. There will be no negative impact on the other facilities in this area.

Within Dannevirke, the park is designed for children under 13 therefore rangatahi do not have any other space that they can call their own. To give them a space would assist with encouraging our teens to stay active and help stopping the loitering of teenagers on the main street while giving them a space that is safe and visible. For young toddlers and children, the Park contains age suitable playground equipment but no space for wheel sports.

Other sites that were considered for the skate park were the old BMX track between Hamlet and Alexandra st however; this was not supported by local residents. DMCI also looked into the space behind the scout hall at the Upper Domain but the weather station is positioned there and there was some concern about the amount of retaining needed between the upper and lower domain. This would have been very pricey.



9. Proposed Skate Park

The Skate Park will be designed to meet the needs of a range of wheel sports as it recognises that within sports there are fads. This has been part of the committee's strategic plan to future proof the area allowing for it to be a facility that will be utilised for many years. The surface will accommodate scooters, bikes, skateboards and rollerblades. To meet the needs of a wide range of age groups the wheel park will be designed to suit all skill levels. The flow of the wheel park will be designed so that both younger and older children can use the facility freely without impeding each other's space. The size of the park allows for enough area for younger children to practice on flat ground as well as using some small bumps while the teenagers can practice their skills on the steps and jumps.

The Design has yet to be completed as once the funding is accepted, we will liaise with the tamariki, rangatahi and our community to come up with a concept that works for the majority of the users. This will also be going into schools, working with local youth workers, iwi and utilising our Facebook page to reach as many people as we can.

10. Examples of different designs



14

11. Costings

The skate park will be free of charge to all users.

The land that the skate park will be sited on is DOC owned and vested in Council as the managing authority.

DMC have been in contact with BMST in regards to the maintenance of their new wheels park and they had said there is very little. Some spraying weeds and picking up rubbish.

The committee foresees after discussion with the designer that the only ongoing maintenance costs in the future will be repairs from potential vandalism and graffiti.

The skate park company (J Stone) does not recommend any structural upkeep once completed. It is recommended between \$1000-\$2000 per year kept aside for maintenance.

Two companies were contacted to give quotes and propose designs for the skate park. J stone skate parks have had excellent communication and have sent through a breakdown of the stages of the build and the cost.

Rich landscapes are a very well known SkatePark contractor and have come highly recommended. See attached proposal.

It is estimated that the project will cost \$443,966 including GST (New quotation 20.6.23)

1	Preliminary and General Items				
1.1	Contractor's Programme	1.0	LS		
1.2	Concept Design for Skate Park and Pump Track	1.0	LS		3,000.00
1.3	Review of Concept Design	1.0	LS		
1.4	Detailed design and Construction drawings	1.0	LS		1,500.00
1.5	3D Model	1.0	LS		
1.6	Follow up / community engagement Facilitation	1.0	LS		
1.7	Contractor's Reports				
1.7.1	Monthly Reports	5.0	mnt h		
1.7.2	Contract Quality Plan				
1.7.3	Preparation of Contract Quality Plan	1.0	LS		
1.7.4	Management of Contract Quality Plan	5.0	mnt h		
1.7.5	Site Specific Safety Plan				
1.7.6	Preparation of Site Specific Safety Plan	1.0	LS		

1.7.7	Implementation of Site-Specific Safety Plan	5.0	mnt h		
1.7.8	Environmental Control Plan				
1.7.9	Preparation of Environmental Control Plan	1.0	LS		
1.7.10	Implementation of Environmental Control Plan	5.0	mnt h		
1	Subtotal of Section 1				
2	PRELIMINARY + GENERAL				
2.1	Establishment of work site; construction administration, quality control; site safety; pedestrian management; surveying and setting out; identification and protection of existing services; silt control; protection of existing trees to be retained.	1.0	LS		\$13,500.00
2.4	Establish accomodation for the road crew for the duration of the project.			\$24,000.00	\$24,000.00
2.5	establishment of onsite storage and security	1.0	LS	\$4,000.00	\$4,000.00
	Subtotal of Section 1				\$41,500.00

3	<u>SITE PREPARATION + DOWN TAKINGS</u>	-	-	-	-
3.01	<u>CUT AND STOCKPILE/ REMOVE LAWN. Cut topsoil to depth of 200mm and stockpile 150m³ onsite for later garden establishment (1310m²). Remove remainder of material from the site</u>	<u>1.0</u>	<u>LS</u>	<u>\$6,500.00</u>	<u>\$6,500.00</u>
3.02	<u>CUT AND FILL: Cut and Fill Subgrade material to required levels</u>	<u>1.0</u>	<u>LS</u>	<u>\$10,600</u>	<u>\$10,600</u>
3.03	<u>EXISTING TREES AND VEGITATION: Cut and Remove from site</u>	<u>1.0</u>	<u>LS</u>	-	-
-		-	-	-	-
-	<u>Subtotal of Section 2</u>	-	-	-	<u>\$17,100.00</u>
-		-	-	-	-

	<u>General Quantities for Main Street Skating Area (Including Pool Bowl Platform)</u>	-	-	-	-
--	--	---	---	---	---

<u>BASE COURSE: Supply and Install compacted Gap20 over area to required levels.</u>	tonne	420	\$ 150.00	\$63,000.00
<u>SUBSOIL DRAINAGE: Supply and Install drainage metal and conduit as required into drainage swail</u>	tonne	6	\$ 150.00	\$900.00
<u>DRAIN; bottom of bowl to pump station or soak fiels</u>		-	provisional	\$8,000.00
<u>STARTER BARS: Supply and Install 0.6m D10 Starter bars into all abutting concrete joints @ 400 CTRS (Excluding Pool Bowl Starter Bars)</u>		-	-	included in price for other feature
<u>sealer/desyifier</u>	M2	-	-	\$3,200.00
<u>CONCRETE Main skate park slabSLABS supply and install SE62 Reinforcing Mesh and supply/ install 120mm thick 30MPa 13mm aggregate concrete with oxide. Allow min. 2% cross fall and 1/4 depth of slab x 3mm wide saw cuts at required intervals. U3 Finish</u>	M2	400	\$87.00	\$34,800
<u>CONCRETE SEALER, Chemtech One</u>	-	-	\$2,800.00	\$2,800
<u>SUB-TOTAL SECTION 3</u>	-	-	-	\$ 112,700.00

<u>Skate Park Area Skate Features (excluding earthworks and base course prep)</u>	-	-	-	-
<u>1/4 pipe hip</u>	1.00	LS	-	\$10,400
<u>1M 1/4pipe</u>	-	-	-	\$11,700
<u>1M corner 1</u>	-	-	-	\$11,950
<u>1M corner 2</u>	-	-	-	\$11,950
<u>1M 1/4 pipe facewall</u>	-	-	-	\$11,700
<u>ledge and manual pad</u>	-	-	-	\$8,900
<u>flatrail</u>	-	-	-	\$1,200
<u>entry stairs 4 stair</u>	-	-	-	\$3,000
<u>volcano</u>	1.00	LS	\$8,316.00	\$8,316
<u>Kindey Bowl; 1M shallow end, 1.4M deepend</u>	-	-	\$ 130,000.00	\$130,000.00
<u>Subtotal Section 4</u>	-	-	-	\$209,116.00

<u>Pump Track</u>	-	-	-	-
<u>3 Corner berms: supply and install 120mm of 30 MPA pump mix concrete, reinforced with SE 62 mesh,</u>	1.00	LS	\$25,000.00	\$25,000.00

<u>Double blaster bump, two flat entry rollers with a half high mid section</u>	<u>1.00</u>	<u>LS</u>	<u>\$8,150.00</u>	<u>\$8,150.00</u>
<u>5 PUMP BUMPS, 300mm-500mm high 2M transitions</u>	<u>1.00</u>	<u>LS</u>	<u>\$18,000.00</u>	<u>\$18,000.00</u>
<u>Slab: 120 mm thick 30 pump mix concrete reinforced with SE 62 mesh finished to F5 full reflective surface</u>	<u>123</u>	<u>M2</u>	-	<u>\$9,225.00</u>
<u>pump track flat slabs</u>	<u>13</u>	<u>75</u>	<u>\$75.00</u>	<u>\$975.00</u>
<u>Sealer/densifier</u>	<u>1.00</u>	<u>LS</u>	<u>\$ 200.00</u>	<u>\$200.00</u>
	-	-	-	<u>\$ -</u>
<u>Subtotal 5</u>				<u>\$ 61,550.00</u>

<u>REINSTATEMENT OF SITE</u>	-	-	-	<u>\$6,000</u>
<u>Remove all construction debris from site, fill in top soil as needed, plant grass seed in preparation for final inspection</u>	<u>1</u>	<u>No.</u>	<u>\$ 2,000.00</u>	<u>\$ 2,000.00</u>
<u>Subtotal</u>	-	-	-	<u>\$443,966</u>
<u>Subtotal of all works associated with project.</u>				<u>442,966</u>

See appendix for second proposal from Rich Landscapes.

12. Ownership and Management

DMC plans to fund and project manage the entire build of the skate park. On completion we wish to present the facility to the council and collaboratively come up with a future management and operation agreement.

We hope that together DMC and the TDC can collectively work together to ensure the rate payer does not have to be burdened by this project and that it can benefit our wider community.

13. Project Funding and Timeline:

As we continue to apply for funding DMC asks for support from TDC as they are the land owners. A letter would be required to aid funding applications.

Starting the construction work is dependent only on raising the required funding.

The following is a proposed funding timeline.

This would be dependent on the success of funding applications. DMC recognizes that funding can change from year to year and that we may need to re-evaluate our plan as time goes on.

DMC would like to report to the council with updates on applications within the next year.

Grant Applications

Fund	Closes	For (amount)	For (purpose)	Status
Pub Charities	Monthly rounds	20,000	Design	Preparing application
Lions Club	Always open	3000	Design	Application pending
ECCT (Grassroots Fund)	Monthly rounds	75,000*	Project Costs	Nil
Grassroots Central	Monthly rounds generally closing last day of month	50,000	Project costs	Nil
Lion Foundation 2008	Always open, at least 8 weeks to process	30,000	Project cost	Nil
TAB Grants	Monthly rounds	50,000	Project cost	Nil
ECCT (CAFF Fund)	Not available until next year.	100,000	Project cost	Nil
Total funds to be applied for:	\$328,000			

Other Fundraising Activities

Activity	Description	Status	Fundraising Goal
On Board Skate Day	Skate lessons for children along with a sausage sizzle and other activities for kids.	In planning phase with ON Board Skate team	\$2000
Family Fun Run	Community run for the family. Range of distances. Prizes for placing.	Beginning planning phase	\$2000
Golf tournament	Ambros team competition. Different activities around the course.	Nil	\$5000
Quiz night	Team quiz night. Spot prizes, place prizes, raffles to be sold. Items to be auctioned.	Nil	\$5000

Local Sponsors (Gold, Silver Bronze)	We will be asking the local community for sponsorship. There will be a sponsors board located at the park	Nil	\$20,000
Total funds to be raised:	\$34,000		

Other Funds

Source	Status	For (amount)	For (purpose)
TDC Recreation Reserve Fund	Pending council consideration	80,000	Projects Costs
TDC Better Off Funding	Pending council consideration	50,000	Project Costs
Total funds secured to date:	\$0.00		

Example of sponsor board.



14. Conclusion

The Skate Park is an exciting initiative by a group of enthusiastic volunteers who believe that this will be a great asset to the Dannevirke community and is long overdue for our tamariki. The community as a whole will benefit, from toddlers learning new wheel sport skills in a safe environment to teenagers who won't have to travel out of town to use another facility and will have an area they can make their own. With the addition of picnic tables, seating and playground equipment as the final stage for the project, the committee aims to make this area a family friendly environment that will add to the already busy park. It will assist in creating the "Hub" that is the vision of DMCI with the majority of sport and recreation being held at the upper domain.

"Places, people, families/whānau at the centre of planning decisions and design to best meet the needs of their community. Providing local solutions for local issues" (Taranui Health and Wellbeing plan).

16. Supporting Documents

Huia Range school

South School

Totara College

St Joseph's School

Te Kura Kaupapa Māori o Tamaki Nui A Rua

Jamie Hape, Youth Mentor – Te Kahu Manaaki Rangatahi

Jono Harrison, youth worker Te Kete Hauora o Rangitane

Police - sergeant Gary Mckernon

Dannevirke cricket club

Dannevirke Athletics Club

Dannevirke Jnr Football

Community Survey

Hawke's Bay Today articles

Rich landscape proposal

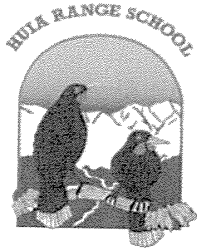

Huia Range School

Cole Street
Dannevirke

Phone 06 374 6444
Cell 0277812224

Email: office@huirange.school.nz

Tararua District Council
Gordon Street
Dannevirke

1st March 2022

Kia Ora Koutou

A lot of our students have been writing letters to you to support the proposal for a new 'Skate Park' for Dannevirke youth.

A couple of years ago, when the council sent out the Domain Design competition Huia Range School students took part and submitted plans and concept designs to support this initiative.

Overwhelmingly time and time again students included a skate park area in the original Domain submissions. When asked why, given that there is already an older skate park operating near the old fire station in Allardice Street the students themselves feedback the following:

- the old skate park is getting very old and tired.
- they (the kids) are not allowed at the old one as it is unsupervised and unsafe tucked away where it is.
- a lot of issues happen due to older kids thinking no-one is watching.
- there is not a lot to do there.
- it is not big enough when a lot of kids are down there.
- students don't feel safe at the old one.

Building a new skate park in its proposed new location would mitigate a lot of these issues associated with the old skate bowl.

While adult supervision is encouraged the reality is that a lot of kids are sometimes around town on their own and they need to feel safe. I think it would be a great asset for the community and council.

Kindest regards

Lindsey Randall
Deputy Principal
Huia Range School

Received

4 APR 2023

Dvka Service Centre

26 Gordon Street
Dannevirke 4930

10th March 2023.

Dear Tararua District Council

Have you ever been at a skate park that doesn't have many bowls, ramps or curves?

Estin and Hariem would love to have a new skate park down at the Dannevirke domain. Here are some reasons why we want to have it at the domain.

The reasons for shifting the Dannevirke skate park.

1. The skate park we have is too small.
2. The skate park is too dangerous for little kids.
3. Too many people crash into each other when there are people here.

Have you ever been to a skate park that's too small and dangerous for little kids?

The dannevirke skate park is so dangerous that even older kids can not go in it. The skate park doesn't even have any toilets to use either. We have had the similar skate park for so long that we can not even remember the date it was built. Nobody comes to our Skatepark today because younger kids do not like the steep drops we have and the older kids do not go there. It is basically isolated.



The new skate park should have...

Multiple ramps, bowls, curbs and rails so that many skaters can be making runs simultaneously. Concrete bowls, mini ramps, lots of transition, larger half pipe or vert ramp, not just small rails and ledges and street obstacles.

We need to make the park so that you can have a good run on a scooter or skateboard. It needs to be made suitable for experienced and amateur riders. There should also be sitting and resting spots. This new skate park may also contain handrails, funboxes, stair sets, quarter pipes, ledges, spine transfers, pyramids, banked ramps, full pipes, snake runs, and any number of other objects. There should be a fence in the skate park to control access and there should be some shade to rest when we get hot. A water fountain would also be beneficial.

It would be important to keep out the children that are under 1-4 years old so that they do not get injured. We also need to keep out animals and protect bystanders. The new skate park should have some toilets for men, women, boys, girls and a family room for babies to go into. It should also be a nice and calm environment for you to make friends

This is the design we made for the new skate park.

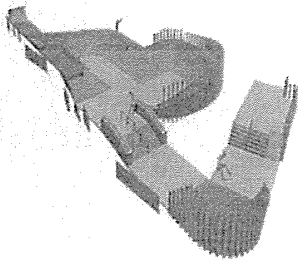

OR

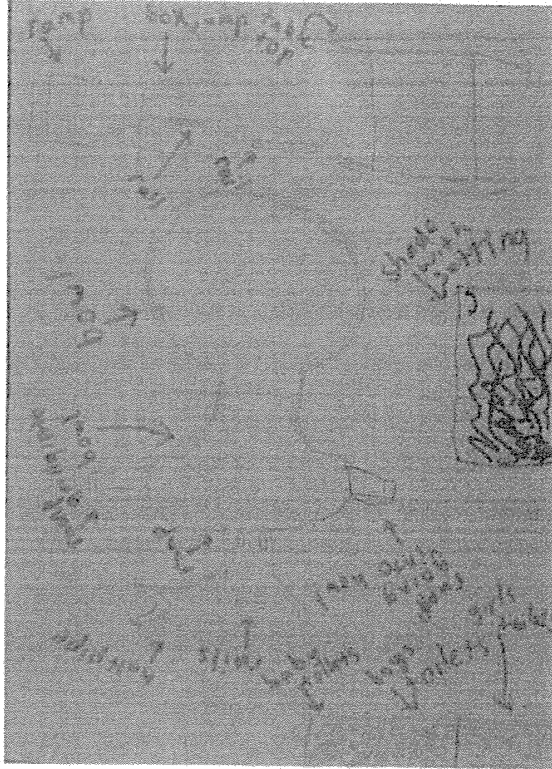

We look forward to hearing from you in the near future.

Yours faithfully

Estin
Harlem

Harlem and Estin.

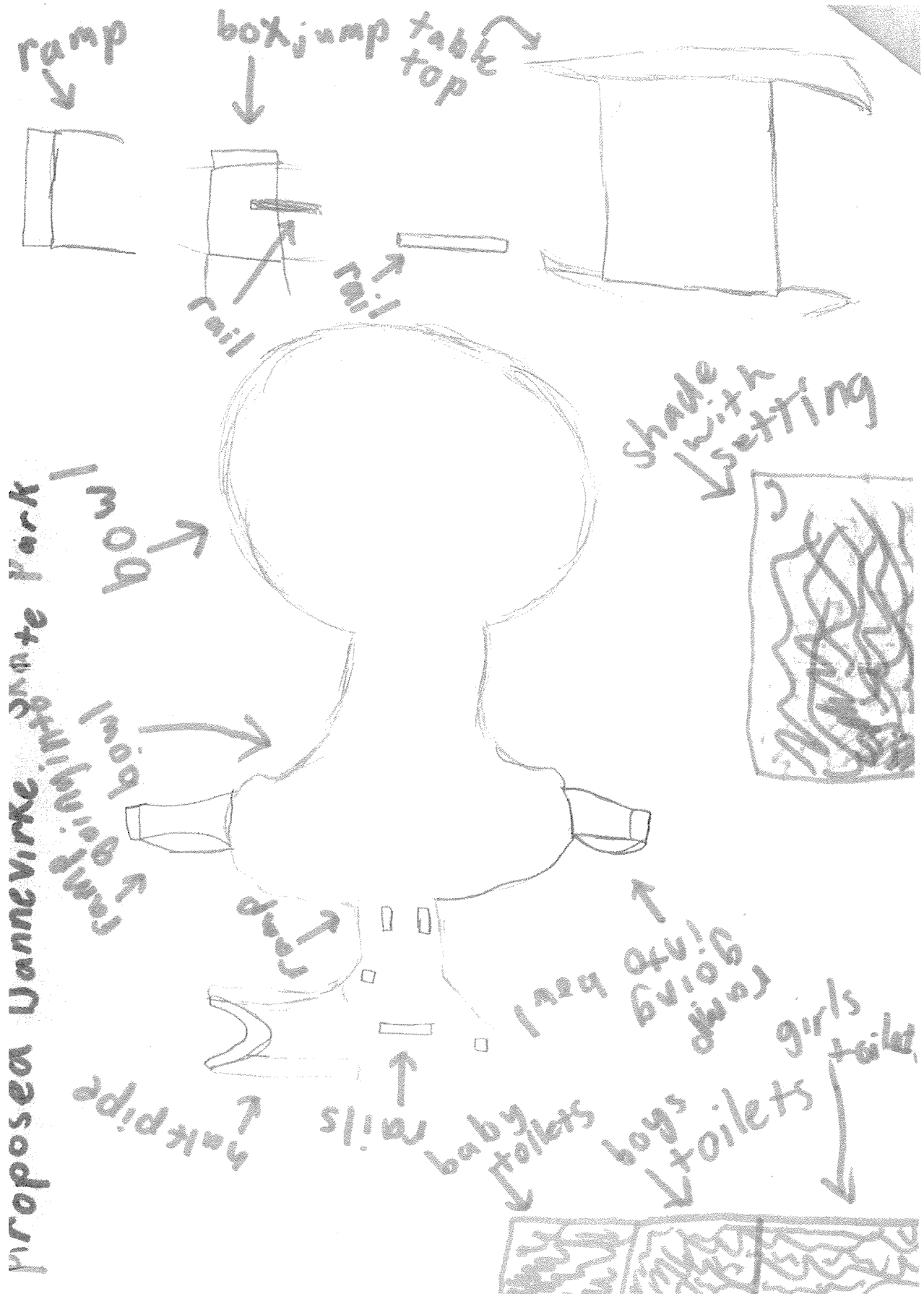

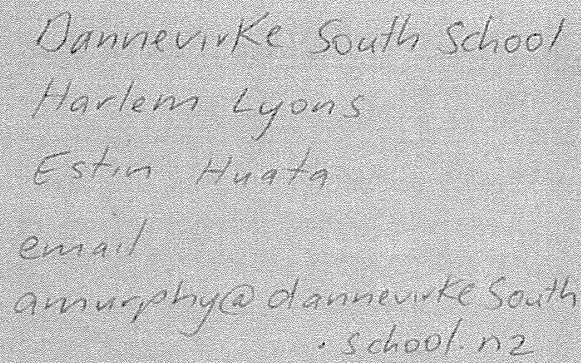

Dannevirke South School
Harlem Lyons
Estin Huata
email
amurphy@dannevirke South
school.nz

TOTARA COLLEGE
of Accelerated Learning



Tararua District Council
Dannevirke

2 March 2022

To whom it may concern

Re: Skatepark for Dannevirke Youth

As a parent of two boys (now adults and who still use skateboards) and as a member of the Totara College community and staff, I would like to endorse and support the idea and concept of a replacement skatepark for our Dannevirke youth.

I believe the existing skate bowl has served its purpose and outlived its use. The youth of Dannevirke deserve a more modern and larger facility with access to public toilets.

By having the skatepark area at the Upper Domain and near Wai Splash, it would be a safer area for the riders, the public and the many different types of 'wheels' (skateboard, scooters etc) that would use the new facility.

The Upper Domain area is also a good site as families regularly use the playground and the swimming pools. It would be useful for generations to come.

Yours sincerely

Sue Holdaway

*Sue Holdaway
Office Administrator
Totara College of Accelerated Learning
3 Ruahine Street,
P.O. Box 152, Dannevirke 4942*

"THE SCHOOL OF TODAY, FOR TOMORROW"

3 Ruahine Street, P.O. Box 152, Dannevirke 4942
E-mail: principal@totaracollege.school.nz

Telephone: 06-374-6165
Fax: 06-374-6170

2nd March 2022

To whom it may concern

I am writing to put forward my support for the new proposed 'Skate Park' in Dannevirke.

I believe that having a skate park attached to our upper domain and near Wai Splash would be the best for visibility, safety and also enjoyment for our young people in Dannevirke.

Our young ones need a space to use up their energy, grow in confidence, be seen therefore keep safe and meet up and make friends.

I am thankful for the opportunity to put forward to our Council my support of the proposal and am hopeful that we as a district can see a 'New Skate Park' eventuate.

Yours sincerely



Ruth Peters



Deputy Principal

Totara College of Accelerated Learning

3 Ruahine Street,

P.O. Box 152, Dannevirke 4942

New Zealand

Ph: 06) 374 6165

Fax: 06) 374 6170

e-mail: ruth@totaracollege.school.nz

171 High Street
Dannevirke, 4930
P | 06 374 9224



PO Box 97
Dannevirke, 4942

Ngāti Kahungunu ki Tāmaki-nui-a-Rua
171 High Street, Dannevirke 4930
06-374-9224
jamie@kahungunutar.co.nz

Dannevirke Skate Park Project

To whom this may concern

I am one of the youth mentors for Ngati Kahungunu ki Tamaki-nui-a-Rua, and I am writing on behalf of our NKKTNAR kaimahi to express our support for the proposed skate park project here in Dannevirke.

As an active member of this community and an advocate for recreational opportunities for all, we firmly believe that a skate park would bring numerous benefits to our residents, especially our youth. By providing a dedicated space for skateboarding, it can encourage active and healthy lifestyles while also promoting social cohesion and providing a space for personal growth and community engagement.

We look forward to hopefully seeing this project progress into something that will benefit our community.

Warm regards,

A handwritten signature in black ink, appearing to read "Hape", written in a cursive style.

Jamie Hape
Youth Mentor – Te Kahu Manaaki Rangatahi

"To have a thriving community with strong and trusted leadership, building a better future for Kahungunu peoples, all Māori, all Iwi, and all peoples in the Tāmaki nui-a-Rua rohe"



Rangitāne o Tamaki nui-ā-Rua Incorporated

18/05/2023

Te Kete Hauora o Rangitāne
10 Gordon Street, Dannevirke
06 374 6860

To whom this may concern,

I am a Youth Worker at Te Kete Hauora o Rangitāne and am writing in support of the proposed Project for the new skate park and for the location to be at the Domain.

This is a well utilised area and provides recreational activity for the entire whānau at a more central place. I believe that this proposed plan will be more beneficial supporting active and healthy whānau relationships whilst also providing a safer and more open space for all rangatahi and whānau to spend quality time.

I look forward to seeing this proposed plan progress into fruition and can see the benefits this will bring our Community.

Nga Manaakitanga,

Jono Harrison
Kaimanaaki Taiohi
027 444 2580
Jono.harrison@rangitane.co.nz



Sergeant Gary MCKERNON
13 GORDON STREET
DANNEVIRKE

Tel - 06 3744500

23/04/2023

Reference: - Dannevirke Skate Park project

To Whom it may concern,

I am currently the Sergeant in charge of Dannevirke police station. I am writing a letter of support of the proposed Skate Park in Dannevirke

The proposed site is at the Upper Domain in Dannevirke which has good CCTV coverage and is well used by the local community. To have a Skate Park there would open it up to more families and what we consider to be a safe space.

The new facility would also give the youth of our community focus and interest in outdoor activity and give them some ownership and pride in the town which leads to more youth engagement for ours and other services.

We look forward to seeing the project progress.

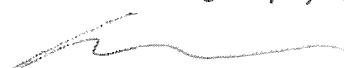

Yours faithfully

Sergeant Gary MCKERNON

Safer Communities Together

DANNEVIRKE SPORTS CLUB INC.

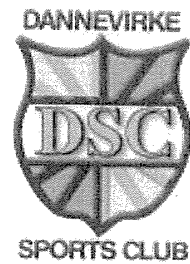
P O Box 229, Dannevirke 4930



18 July 2023

Sam Jones

DMCI Activation Manager

On behalf of the Dannevirke Cricket Club we wish to advise they have visited the domain to view where the new skate pool would be located.

The Dannevirke Cricket Club feel the location on the other side of the white fence at the old paddling pool area is the best location for the skate pool and it will not impinge on their sporting activities.

Thank you.
Yours faithfully

Dannevirke Sports Club Inc.
Janine Boyden
Secretary

www.sportsground.co.nz/dannevirkesportsclub dannevirkesportsclub@gmail.com
06 3746478

Dannevirke Athletics committee

Kelly Gillard

Jul 5,
2023,
10:16
AM

Morning team can you please reply to Sam that you agree to moving the skate park from the Athletic track area and over to towards the grassed p area near the water fountain and by the round Concrete garden. Cheers

Yes Sam I 100% agree to this idea.

Cheers and thank you so much for your support with helping to find alternative venues,

Kelly Gillard, Dannevirke Athletic Club

Kirsten Prenter <kuti-babe@hotmail.com>

Jul 5,
2023,
10:55
AM

Hi Sam



Yes, I agree with the new space for the skate park. A great spot that suits

everyone



Kirsten Prenter

Frances <francesmcdonald10@hotmail.com>

Jul 5,
2023,
11:05
AM

Morning Sam,

I am very supportive of a new area for the Skate Park. It's important to our Dannevirke children and whanau that we continue to offer a wide range of sporting and recreational facilities, including new and existing activities. Thanks for making this possible.

Frances Cammock
Dannevirke Athletics Club

Q1 Do you believe there are enough activities in our recreational spaces for the youth in Dannevirke?

Answered: 305 Skipped: 0

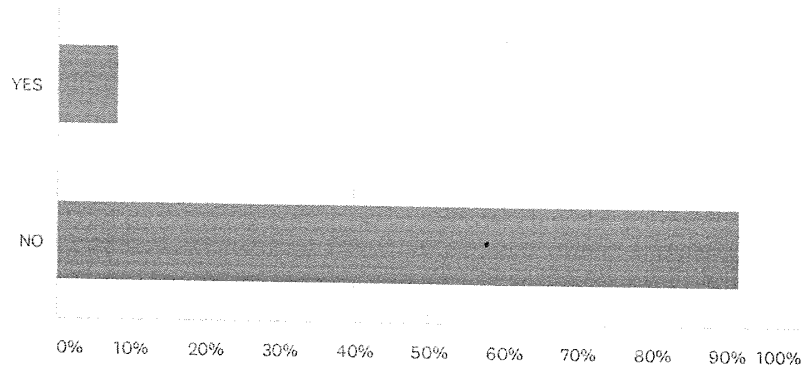

ANSWER CHOICES	RESPONSES	
YES	8.20%	25
NO	91.80%	280
TOTAL		305

Q2 How important are the following features to you in regards to a recreational space?

Answered: 305 Skipped: 0

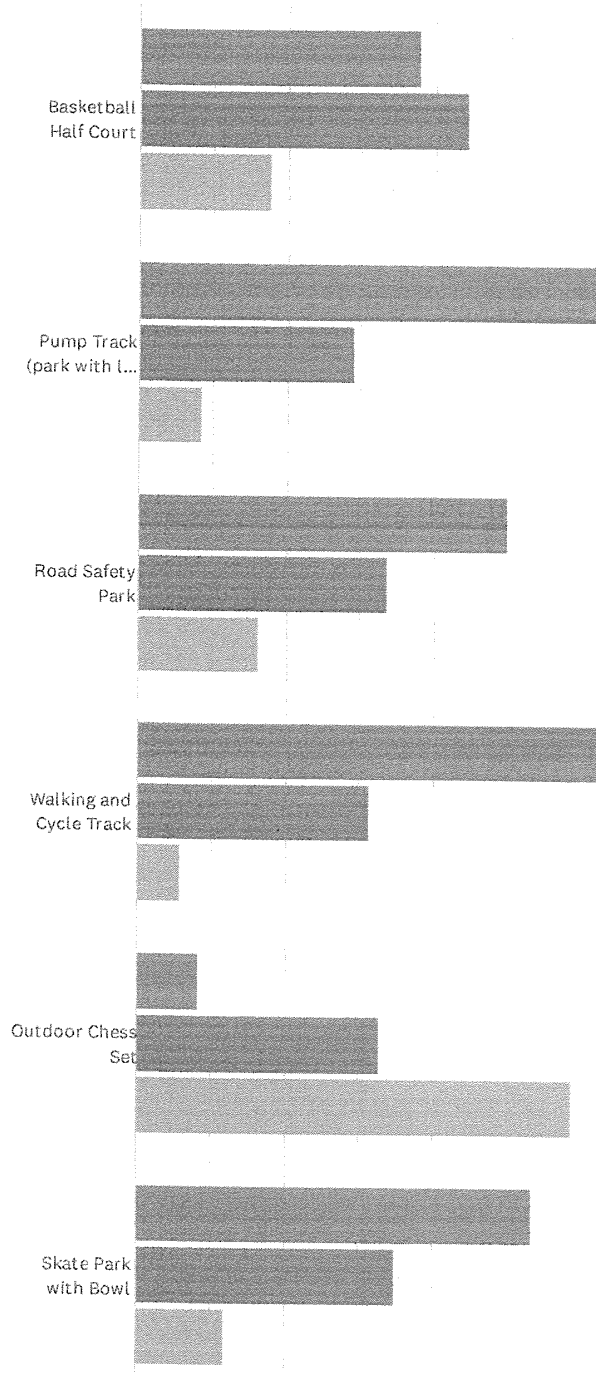

Dannevirke Recreational Space Survey

SurveyMonkey

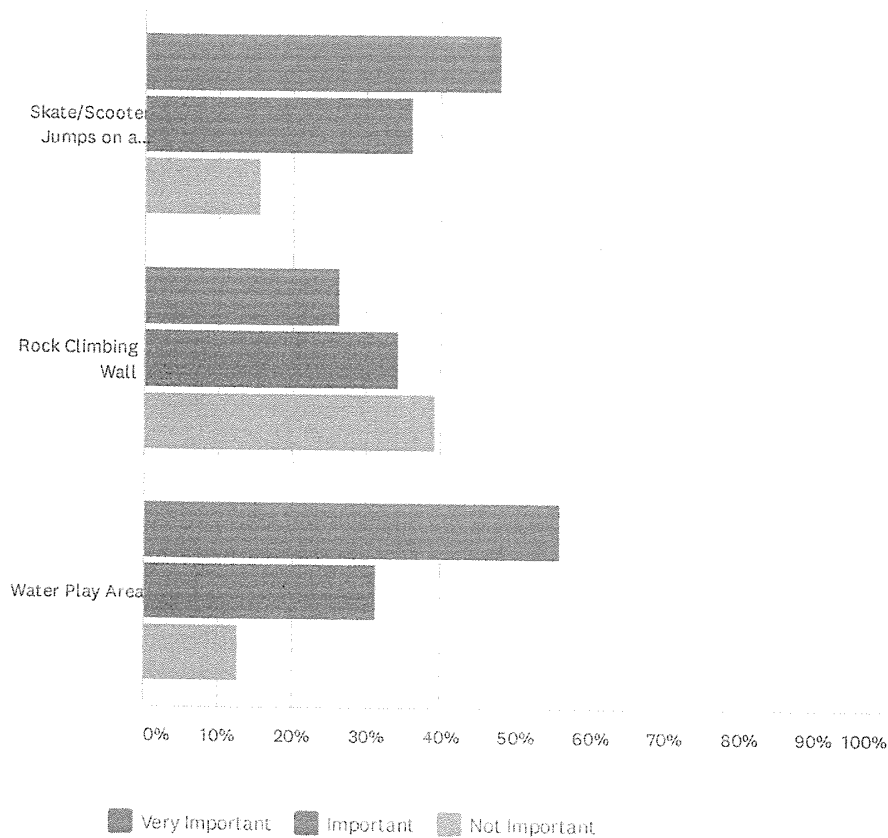

	VERY IMPORTANT	IMPORTANT	NOT IMPORTANT	TOTAL
Basketball Half Court	37.92% 113	44.30% 132	17.79% 53	298
Pump Track (park with lots of bumps and bends for bikes and scooters)	62.38% 189	29.04% 88	8.58% 26	303
Road Safety Park	49.83% 149	33.78% 101	16.39% 49	299
Walking and Cycle Track	62.71% 190	31.35% 95	5.94% 18	303
Outdoor Chess Set	8.36% 25	32.78% 98	58.86% 176	299
Skate Park with Bowl	53.29% 162	34.87% 106	11.84% 36	304
Skate/Scooter Jumps on a Concrete Pad	48.17% 145	36.21% 109	15.61% 47	301
Rock Climbing Wall	26.33% 79	34.33% 103	39.33% 118	300
Water Play Area	56.00% 168	31.33% 94	12.67% 38	300

Q3 How important are the following to you with regards to a recreational space?

Answered: 305 Skipped: 0

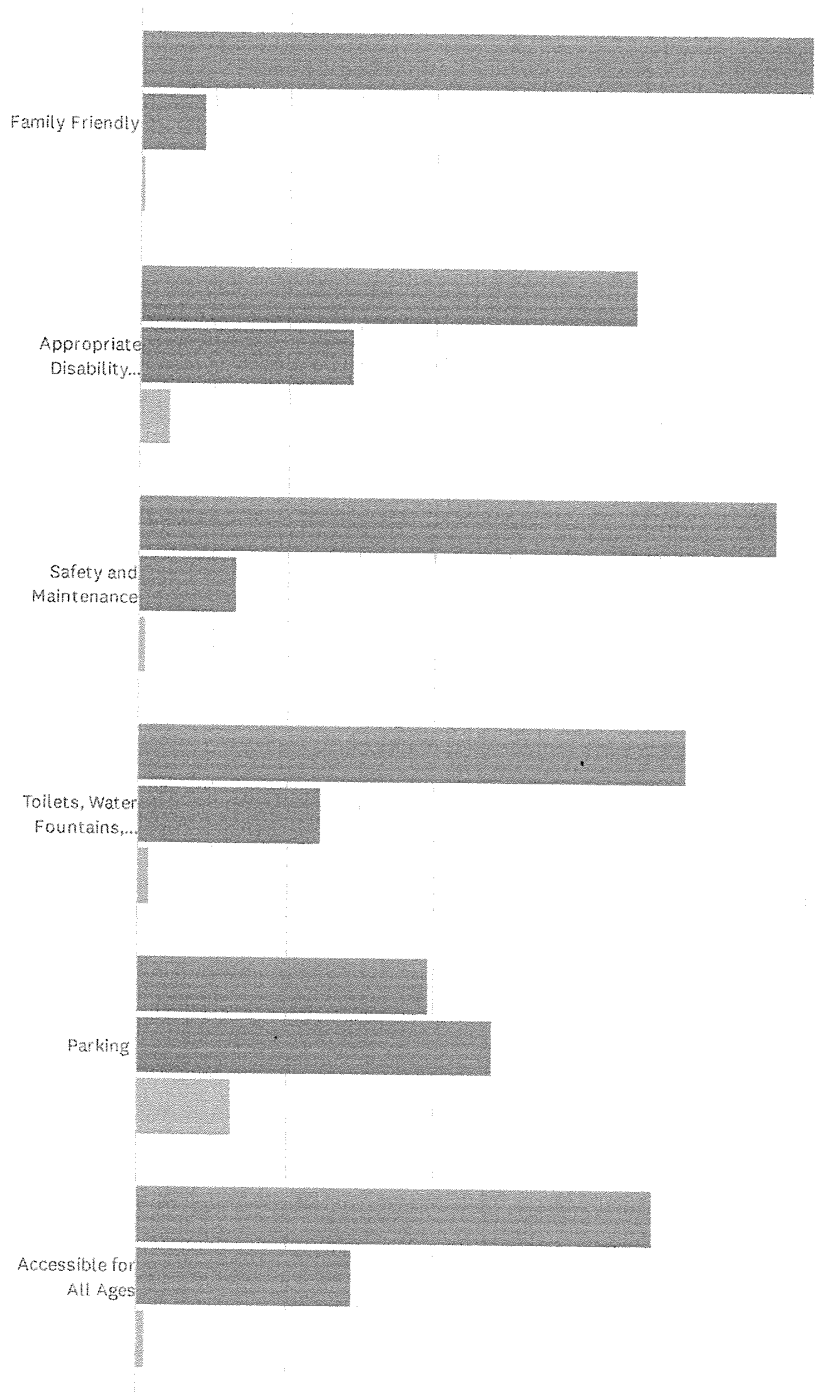

Dannevirke Recreational Space Survey

SurveyMonkey

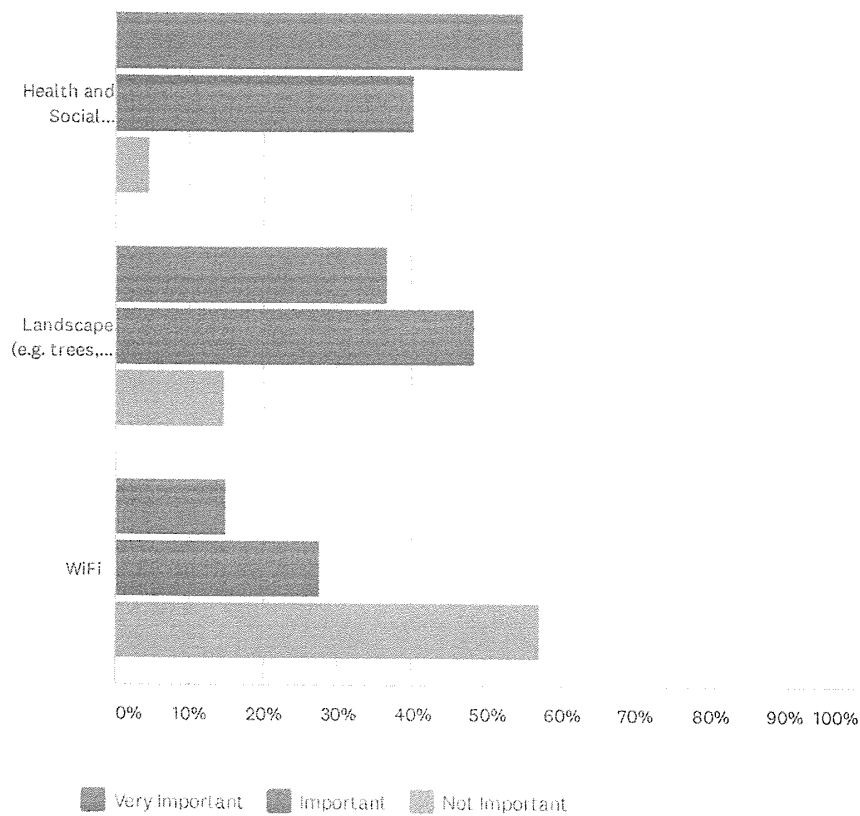

	VERY IMPORTANT	IMPORTANT	NOT IMPORTANT	TOTAL
Family Friendly	90.49% 276	8.85% 27	0.66% 2	305
Appropriate Disability Access	66.89% 204	28.85% 88	4.26% 13	305
Safety and Maintenance	85.90% 262	13.11% 40	0.98% 3	305
Toilets, Water Fountains, Seating	73.77% 225	24.59% 75	1.64% 5	305
Parking	39.34% 120	47.87% 146	12.79% 39	305
Accessible for All Ages	69.51% 212	29.18% 89	1.31% 4	305
Health and Social Connections	55.08% 168	40.33% 123	4.59% 14	305
Landscape (e.g. trees, plants)	36.72% 112	48.52% 148	14.75% 45	305
WiFi	15.08% 46	27.54% 84	57.38% 175	305

Q4 What recreational space (park or reserve) do you currently use?
 Please tick all that apply.

Answered: 305 Skipped: 0

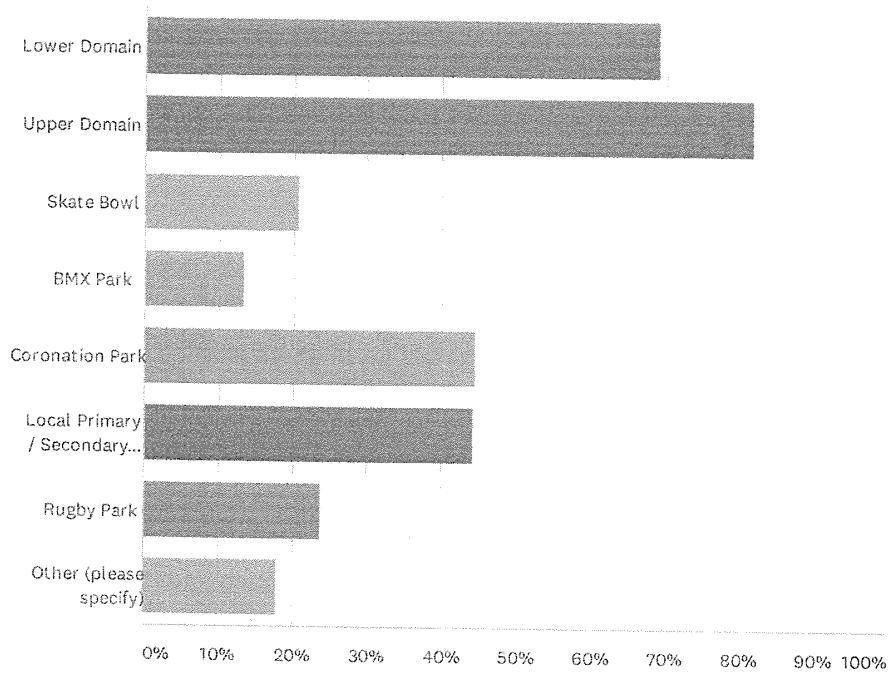

ANSWER CHOICES	RESPONSES
Lower Domain	69.18% 211
Upper Domain	81.97% 250
Skate Bowl	20.66% 63
BMX Park	13.44% 41
Coronation Park	44.59% 136
Local Primary / Secondary Schools	44.26% 135
Rugby Park	23.93% 73
Other (please specify)	18.03% 55
Total Respondents: 305	

Q5 If you are not currently using a recreation space (park or reserve) in Dannevirke, please tick all the reasons why.

Answered: 289 Skipped: 16

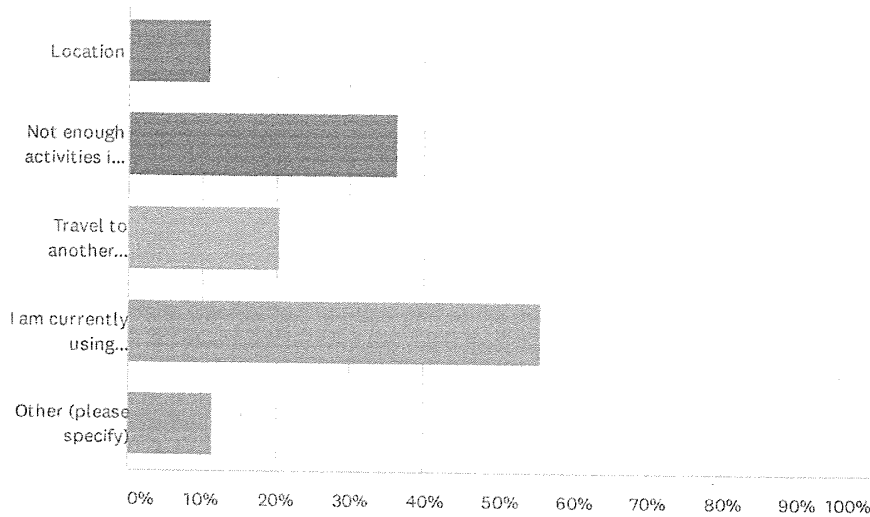

ANSWER CHOICES	RESPONSES	
Location	11.07%	32
Not enough activities in the park/reserve	36.33%	105
Travel to another recreational space in another town/city	20.42%	59
I am currently using Dannevirke recreation spaces.	55.71%	161
Other (please specify)	11.42%	33
Total Respondents: 289		

Q7 What is your gender?

Answered: 305 Skipped: 0

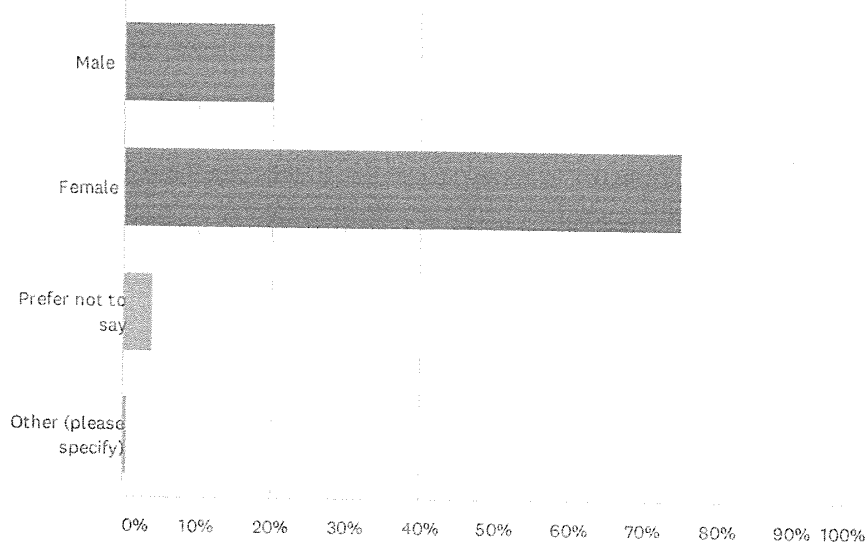

ANSWER CHOICES	RESPONSES	
Male	20.33%	62
Female	75.08%	229
Prefer not to say	3.93%	12
Other (please specify)	0.66%	2
TOTAL		305

Q8 What is your age?

Answered: 305 Skipped: 0

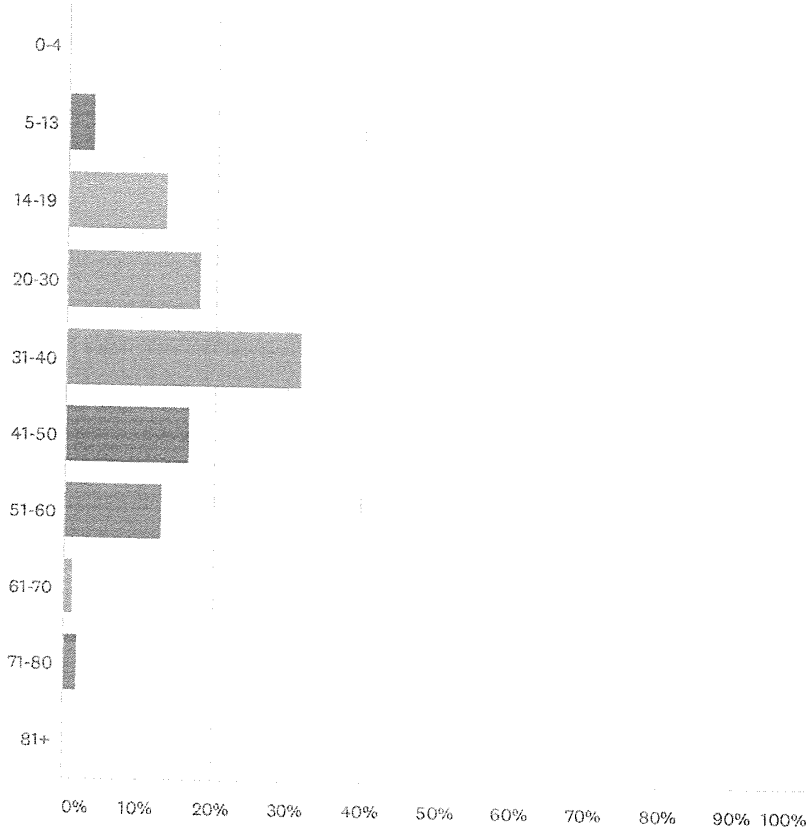

ANSWER CHOICES	RESPONSES
0-4	0.00% 0
5-13	3.61% 11
14-19	13.44% 41
20-30	18.03% 55
31-40	31.80% 97
41-50	16.72% 51
51-60	13.11% 40
61-70	1.31% 4
71-80	1.97% 6
81+	0.00% 0
TOTAL	305

6/2/2018

Deputy mayor Allan Benbow, back, left, community board deputy chair Pat Walshe, councillor Carole Isaacson, mayor Tracey Collis and community board member Terry Hynes meet skatepark campaigners.

Our mayor's door is wide open to young people in the community and a group of them desperate for a better skatepark in Dannevirke have made the most of her invitation.

Taking Tararua District mayor Tracey Collis at her word, four young people called on her recently, urging the council to consider building a new skatepark.

<https://www.nzherald.co.nz/hawkes-bay-today/news/young-campaigners-roll-up-to-mayor-with-skatepark-plea/4C3NFOUAMO3XHOOIMP4OHE...> 2/4

"If they want something, I want them to know they can come into council offices," Mrs Collis said.

"This is the next generation who will be working with council and I want their first engagement with council to be positive.

"They were very excited about their project and it was fantastic they wanted to work with council. This was a really neat way to connect with our young people."

Tararua District councillor Jim Crispin said he was aware people were travelling out of town to Pahiatua, where the new wheels park had opened at the former saleyards and to Waipukurau to use that town's skatepark.

"The young people have taken some flak about the state of Dannevirke's skatepark from those in other towns and we are adamant we don't want that," Mrs Collis said.

"The southern part of Tararua are extremely fortunate to have funding which isn't available to groups in northern Tararua, but I'm sure if we all come together, we can make their dream of a new facility here in Dannevirke come true."

Riwai Aupouri previously told the *Dannevirke News* the young people wanted to be able to do better tricks and have facilities such as a half pipe.

Alex Boblea said the current skatepark was "a bit boring".

"You just skate down, then up the other side," he said. "We'd like a bigger area."

The young people had taken a professional approach to their campaign, organising a petition and T-shirts which promoted their cause, which impressed Mrs Collis.

"They've put in the effort and now it's time for council and other organisations to come together to make it all happen," she said.

Councillor Shirley Hull said Pahiatua had set a precedent with their new wheels park and the Dannevirke project could tap into their scope of work and how to fund a skatepark.

Mrs Collis agreed.

25/1/2020

Caleb McCutcheon is airborne out of the Dannevirke skatebowl. Photo/Dave Murdoch

BTG200120SP1 Caption: Caleb McCutcheon is airborne out of the Dannevirke skatebowl.

Photo/Dave Murdoch

Story by Dave Murdoch

DANNEVIRKENEWS

NEWS

Dannevirke youths are hoping the town's Allardice St skatepark will be replaced with one that is on a par with others in similar sized towns.

They feel the existing skate bowl is no longer suitable for the modern style of scootering.

When built over a decade ago it was state-of-the-art, based on others around the lower North Island and some designs from Dannevirke High School Year 12 graphics students.

The skatebowl was jointly funded by Rural Women, Dannevirke Host Lions and Tararua District Council and was built by Mitchell and Greatbatch.

Originally designed for skateboarders, over time it became a mecca for scooter riders and bikers.

In 2016 an EIT Building and Carpentry Training programme built a shelter which was much appreciated.

Over the years it became the focus for top scooter riders attracting outsiders to competitions.

Locals respect their facility which is largely devoid of graffiti and rubbish.

They have their own code of conduct which sees each rider waiting patiently for their turn to use the bowl and thereby avoiding crashes.

But an upgrade is now needed.

Youths say it is dangerous and the concrete is too coarse.

"It eats your skin," according to one teenager.

And they say piping protrudes too far and the ramps make it hard for transitions.

"It is hard to practice at a top level," says Ryan Walker who with Alex Dean competed in the nationals in March 2019.

They say it is too small with the numbers using it and this endangers the smaller scooter riders.

Spokesperson Jamie McDonald says they favour a new site on George St which used to be a BMX Track. This site is sheltered and shaded with plenty of space and is close to the

Domain toilets.

However, local residents are not keen to see a new facility in their backyard.

An informal committee has been working for 18 months looking to resolve the problem and has explored several sites.

Tararua District Council is involved and Mayor Tracey Collis said further investigation should happen now everyone is back from holidays.

She is keen to have the committee explore more options incorporating basketball and a traffic safety park but first she wants the committee to find out more from the young people as to what they want.

Following that there will be public consultation over the options.

Latest from Hawkes Bay Today



Taekwon-Do competitors pack out Hawke's Bay Regional Sports Park

15 Jun 11:25 AM



Mamma Mia! It's showtime!

15 Jun 10:19 AM



PREMIUM

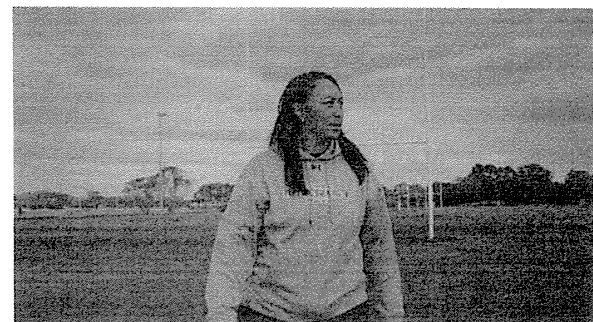

<https://www.nzherald.co.nz/hawkes-bay-today/news/dannevirke-youths-want-skatepark-upgrade/46BDLNRDIYH6SLGYKRQ5O4CRR/>

4/5



25 August 2023

Erana Peeti-Weeber
Deputy Mayor and Chair of the Recreation Committee
Taranua District Council
26 Gordon Street
Dannevirke 4942

Email: erana.peeti-webber@tararua.govt.nz

Tēnā koe Erana,

RE: PROPOSAL FOR DESIGN AND BUILD SERVICES – DANNEVIRKE SKATEPARK AND HALF BASKETBALL COURT

Thank you very much for approaching RICH Landscapes and AMC Skatepark Construction to submit a fee proposal for the design and build services for Dannevirke Skatepark. We look forward to creating and delivering the vision of the project team and local user group.

RICH Landscapes has pioneered the modernisation of premier skatepark and play design in Aotearoa with a vision to see greater accessibility to purpose-built spaces for integrated play, skateboard, and wheel-based communities. Established in 2002, we are an award-winning Landscape Architecture company with extensive experience in skatepark design and consultancy.

Our kaupapa is to focus on sustainable community outcomes and actively engage with local users, tangata whenua and key stakeholders to understand and bring their desired outcomes to life. This approach assists us to design environments that merge social, cultural, and environmental objectives with the creative and athletic needs of current and future communities.

We are a small team of Qualified Landscape Architects who are active skateboarders in our own communities. This personal engagement with the culture of skateboarding drives us to push the boundaries of innovation to design skateparks that inspire creative use and encourage progression at all skill levels.

We believe that communities thrive when they are able to access integrated hubs, these hubs should be a reflection of the people that make up the community and encourage activity, positive participation and social connection. Each community has their own culture, it is important for us to capture this culture within our designs so that when skateparks are implemented they become a part of the collective identity, inspiring people to step into the future together.

Te toto o te tangata, he kai; te oranga o te tangata, he whenua. ("While food provides the blood in our veins, our health is drawn from the land"). As stewards of the land it is vital that our designs consider the needs of nature and promote positive interaction between people and the environment. Every detail of our designs is environmentally considerate; we prioritise the use of locally sourceable materials, have an objective of overall environmental sustainability and incorporate natural features and environmental-collaboration into our spaces. We ensure that our designs have minimal impact on the land while providing positive ways of use that connect people with the land that they inhabit.

We adhere to the CPTED principles of safe and secure environments, ensuring that we design spaces to encourage positive activity and participation while being accessible and open-planned with high visibility. Our methodology has been refined over time and the results of our process of partnering with local communities can be seen in our vast portfolio of projects and communal activity within the skateparks that we have designed.

Angus McMillan Concrete (AMC) has significant experience with skatepark construction and other general building and concrete work. Has been formed out of our enjoyment and self-satisfaction of being able to deliver something different and unique for many to enjoy through the decades.

AMC is a local and privately owned company that was established in 1994 with Angus and Carol working as sole operators, undertaking general building and concrete work. The business started out of the family's garage situated in Farmlet Road, just outside of Hastings.

AMC is a very family orientated business and employs many staff ranging from; excavator operators, boxer/carpenters, concreters, cutters, drain layers and sales staff.

Due to Angus's previous experience in the building industry, they soon became recognized as a provider of quality service and the business started to grow and employ more staff. In 2001, due to the growth in the business they moved the business into a commercial property at 402 Victoria Street, Hastings.

The effect of this quality workmanship and service is that they are now the preferred supplier of boxing, preparation, excavation, concrete placing and finishing, services to many homeowners in Hawkes Bay. The company's success has been achieved through hard work, attention to their customer's needs, innovation in the way they do things and not being afraid to change.

William Nelson Skatepark in Hastings (2013) is the first project AMC and RICH Landscapes delivered together. We subsequently won three industry awards for the Hastings Skatepark, including the NZMCPA (now New Zealand Concrete Contractors Association) Supreme award in 2015.

In 2022 Maidstone Max Tō Tātou Papa Tākaro designed by RICH Landscapes, with all Concrete works constructed by AMC, won the Recreation Aotearoa Playground of the Year Award and in 2021 the Supreme Award for environmental and sustainability by the NZ Concrete Contractors Association.

To date our thriving collaboration has delivered 20 projects together and we are currently building our 21st project in Mt Maunganui, the Tauranga Destination Skatepark.

AMC company values are simple yet realistic. We believe in hard work, honesty, positive change and that our employees are our greatest asset.

Our goal is to be the best in our industry, we believe we are and continue to be.

SCOPE

From our correspondence, the new skatepark and half basketball court will be located adjacent to the Dannevirke War Memorial off State Highway 2 and Christian Street, Dannevirke. Stakeholders of the Recreation Committee have advised that they like the skatepark at Tokoroa, which was built for \$540,000.00 + GST in 2018. The desired design and construction budget is currently \$350,000.00+ GST. The construction cost of the basketball court is not included.

Other goals of the project that we see would include:

- To undertake a thorough co-design process with the TDC and community of Dannevirke so that the park connects with the land and its people.
- To create a cohesive area for people to enjoy
- To create a facility that the community connects and engages with.
- To use sustainable practices where possible to reduce the effect on the environment.

The co-design, also known as collaborative design, is an approach to problem-solving and innovation that involves the active participation and collaboration of multiple stakeholders in the design process. It is a process that brings together designers, end-users, clients, and other relevant stakeholders to collectively create solutions that meet the needs and aspirations of all parties involved.

In co-design, the emphasis is on inclusivity, participation, and shared decision-making. It recognises that the people who will be using or affected by the environment often have valuable insights and expertise that can contribute to its

design. By involving these stakeholders from the beginning, co-design aims to create solutions that are more user-centred, effective, and meaningful.

It promotes a shift from a top-down approach to a more participatory and democratic approach, fostering empowerment, ownership, and social inclusion among stakeholders.

The development of the design for Dannevirke Skatepark and half basketball court will follow the below programme, as outlined in the steps below:

1. Conceptual Design Phase

- Geotech Report and Topographical & Services Study of site to be undertaken.
- Undertake co-design process with the people and other stakeholders to the project.
 - As part of this process RICH Landscapes would come to Dannevirke at the start of the project and engage with the people for a period to gain trust and ensure valuable insights are heard through brainstorming, workshops, interviews, observations, informal one on one meetings, and feedback sessions. (Full process TBC – 3 days situated locally with other visits when deemed necessary by RICH LS and remote interactions as required).
- Establish Key Representatives Co-Design Group from this process.
- Develop design brief from feedback received and send to Client and Key Representatives for review and feedback.
- Amend design brief as required and send to Client and Key Representatives for acceptance.
- On acceptance produce 2D general layout plan – circulate to Client and Key Representatives for feedback.
- Receive feedback and produce 2D concept plan of environment.
- Establish general cost estimate with AMC Skatepark Construction.
- Provide 2D concept and estimate to Client and Key Representatives.

2. Developed Design Phase

- Receive final feedback on 2D concept and cost estimate and approval to proceed from client and key representatives.
- Produce 3D developed design and revise design document for Client and Key Representatives review.
- Release design to wider community through news drop and social avenues and accumulate feedback for next Co-Design meeting.
- Undertake remote co-design workshop with client and key Representatives to run over feedback, amendments, and fine tune skate features for final review.
- Once design accepted by Client and Key Representatives produce quantity schedule for AMC Skatepark Construction to price.
- Deliver final Developed Design and Overall Itemised Price to Client and Key Representatives.

3. Detail Design Phase

- Receive feedback from Client on final design and overall itemised price, and approval to proceed with construction drawings.
- Develop necessary detail documentation to build Skatepark Development.

- RICH Landscapes to discuss key elements with Key Representatives at RICH LS discretion to complete the drawings.
 - Liaison with Structural Engineer for review and PS1 signoff if required.
 - RICH Landscapes/ AMC Skatepark Construction to revise price schedule as required.
 - Deliver final documentation and price schedule to Client.
4. Construction Phase
- On acceptance of construction costs, Angus McMillan Skatepark Construction to develop construction programme and deliver any preliminary or general items before construction commences.
 - Construction undertaken by Angus McMillan Skatepark Construction.
 - RICH Landscapes to conduct Remote Consultation and 2 site visits during the construction phase.

FEE

Conceptual Design	\$15,675.00	
Developed Design	\$9,950.00	
Detail Design	\$25,625.00	
Structural Engineer	\$6,000.00	*provisional sum
Construction TBC	\$398,750.00	*provisional sum
TOTAL	\$450,000.00 + GST	
 OPTIONAL EXTRAS		
3D Animation of design	TBC	
Rendered imagery	TBC	

ADDITIONAL FEE NOTES

RICH Landscapes:

- Design process allows for the phases of feedback indicated in the design phases. Additional consultation phases and deviations from the design proposal will incur variations at our hourly rates shown below.
- Excludes Geotechnical Investigation. RICH Landscapes advises that a Geotech report should be completed to determine stability of land for built infrastructure.
- Excludes Topographical Survey. RICH Landscapes will require a Topographical Survey (in digital and pdf format) to undertake the works involved.
- Excludes Earthworks, Structural and Drainage Engineering. This may be required for the completion of the detailed design documentation.
- Includes calculation of Earthworks Quantities from Earthworks Engineer if engaged.
- RICH Landscapes service is Design only and excludes any planning advice, resource and/or building consent drawings (additional to those produced by RICH Landscapes in the above scope), lodgement and processing.
- If documentation is required to be supplied to third party consultants, they must sign an NDA before the release of documents.
- Permission to use any copyright images must be obtained from RICH Landscapes, and notification must be received prior to publishing by at least seven days.
- The provision of CAD files to the client and associated consultants to the project will be at the discretion of RICH Landscapes.
- General correspondence is included in our fee proposal, however excessive meeting requests will be raised with the client and charged as a variation.

- Additional design phases and deviations from the above stated process will incur variations at our hourly rates shown below.
- Upon engagement, the co-design process and programme with target dates will be developed with the client for review and approval. Extension of feedback deadline dates will likely result in a delay in future phases and will incur variations at our hourly Project Management rate as shown below.
- RICH Landscapes fees are based on a percentage of the construction budget; should the construction budget increase during our engagement, a variation to reflect this increase will be charged.
- Printing of documents has not been including. Printing costs to be discussed if needed.
- Additional work beyond this scope will be discussed and agreed. Hourly rates for variations as follow:
 - General variation:
 - Landscape Architect / Skatepark Specialist @ \$210 + GST
 - Project Management / Administration @ \$140 + GST
 - Where the work required in a variation needs to be conducted as overtime to achieve quick deadlines:
 - Landscape Architect / Skatepark Specialist @ \$420 + GST
 - Project Management / Administration @ \$280 + GST
- Invoices based on progress will be provided at the start of each month with payment required on the 20th of that month.
- All fees are exclusive of GST.

AMC Skatepark Construction:

- Price subject to final Resource Consent conditions.
- Price assumes the site is not subject to any contamination issues.
- Price assumes the site required no archaeological, iwi, NZHPT, heritage or arboricultural investigation, assessment, and reporting.
- Price based on handover of a clear site.

We appreciate the opportunity of being involved with this project and thank you again for considering our services. We look forward to hearing your reply.

Nāku iti noa, nā,



Carol McMillan
Managing Director, AMC Skatepark Construction

MOB 0274 571 402
EMAIL carol@amc.nz
WEB www.amc.co.nz



Richard Smith BLA
Director, RICH Landscapes

MOB 021 101 4988
EMAIL rich@richlandscapes.co.nz
WEB www.richlandscapes.co.nz